

**I754 / I755**  
**CONCEALED STOPCOCK**  
INSTALLATION GUIDE

---

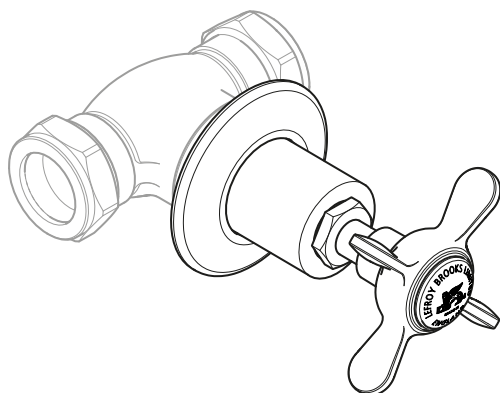

---

LEFROY BROOKS



## IMPORTANT INFORMATION

### **Professional installation**

We recommend that our products are fitted by a fully qualified professional plumber. They should be installed correctly and in accordance with all local water regulations. All products and connections should be accessible for routine servicing.

### **Suits all systems**

This Lefroy Brooks product is potentially suitable for every possible application, type of boiler and water supply pressure.

### **Water quality**

In hard water areas, a suitable water treatment system should be provided to prevent limescale deposits (calcium deposits) which may effect the long term performance of the stopcock. Exterior surfaces should be gently wiped with a dry soft cloth after use to minimise water stains and limescale deposits.

### **Servicing**

All serviceable parts are available to maintain your Lefroy Brooks product. We recommend periodic servicing to help maintain the best performance from your stopcock.

### **Flushing system**

It is most important to flush out all pipework thoroughly before connecting the product.

### **Supply connections**

Please observe the direction of flow as indicated by the arrow on the side of the stopcock. Both 1/2" (15mm) & 3/4" (22mm) pipes are to be installed using the compression connections and olives supplied.

### **Testing**

Before the stopcock valve is sealed behind the finished wall surface it is important to pressure/leak check all connections.

# DIMENSIONS

LBI755 - 1/2" (15mm)

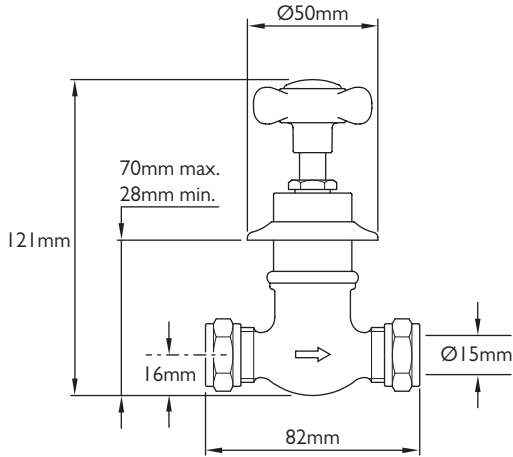

LBI754 - 3/4" (22mm)

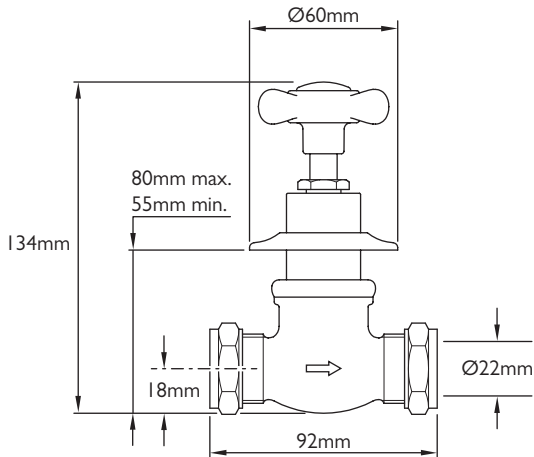

Not to scale

## SERVICING – REPLACING THE WASHER

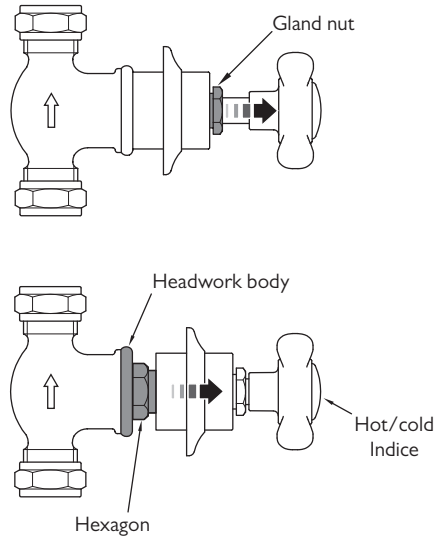

- 1 Unscrew the gland nut fully then slide the shroud and wall plate towards the cross handle/handwheel. This will reveal the headwork body.
- 2 Unscrew the headwork body using the hexagon which should now be exposed.
- 3 If the finished wall surface is built up around the base of the shroud the hexagon may not be accessible. It will therefore be necessary to remove the cross handle/handwheel.

## SERVICING – REPLACING THE WASHER

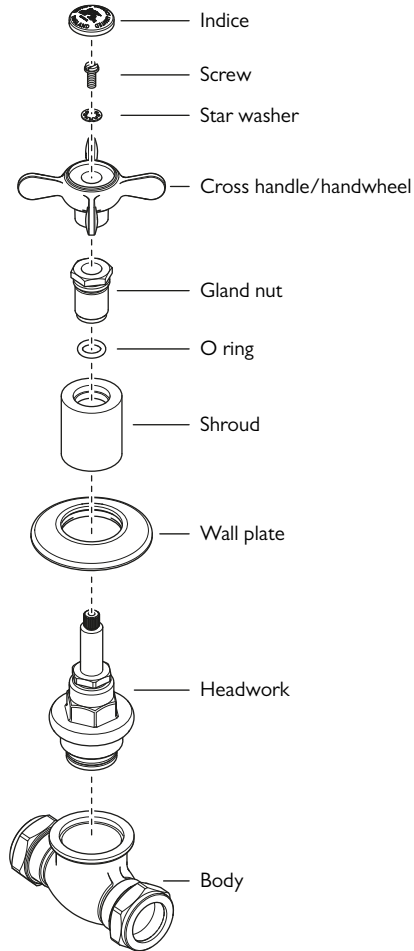

- 4 Remove the hot/cold/lion indice (the indice may have to be broken to remove it).
- 5 Remove the screw and star washer.
- 6 Pull the cross handle/handwheel off the spindle
- 7 The shroud can now be fully removed allowing access to the headwork. Remove the headwork. The washer or complete headwork can now be replaced.
- 8 Assemble in reverse order.
- 9 If it was necessary to break the indice to aid removal of the cross handle/handwheel then a new indice can be ordered via the telephone number at the rear of this guide.
- 10 Ensure that all joints are checked for water leaks.

## REPLACEMENT PARTS

PHL074 – LB 1755 1/2" headwork.

PHL075 – LB 1754 3/4" headwork

PHL010 – Pair of 1/2" washers

PHL011 – Pair of 3/4" washers

---

## FAULT FINDING

Water drips/flows from fittings connected to the stopcock.

- Water dripping from fittings connected to the stopcock is an indication that the washer requires replacement. When removing the headwork take time to check the brass seat of the body for damage. This is the area of the body that the rubber washer seals against. If left to drip for a significant period, water can cut a channel into the brass seat. If such damage is apparent, the seat can be repaired using a 're-seating tool' which is standard equipment carried by plumbers.

Replacing the washer may prevent a drip for a short period of time before it returns. This is a clear indicator that the seat is damaged.



CONTRACT ENQUIRIES

+44 (0)1992 708 316

[info@lestroybrooks.co.uk](mailto:info@lestroybrooks.co.uk)

CUSTOMER SERVICE, SPARES & TECHNICAL ENQUIRIES

+44 (0)1902 390 894

[technical@lestroybrooks.co.uk](mailto:technical@lestroybrooks.co.uk)

LEFROYBROOKS.CO.UK

---

Whilst every effort is made to ensure the accuracy of these, they are subject to change without notice as part of the company's product development process. The use of trademarks, product design and artwork is subject to licence or agreement with LBIP Ltd. The design registrations, trademark registrations and copyrights are protected by law and the use or reproduction outside the terms of an agreement is prohibited. The right to modify designs and dimensions is reserved. LBIP Ltd is a member of ACID (Anti Copying in Design). E&OE